

ESRTPRFK

Programmable Room Thermostat

User Instructions



Thank you for choosing ESi Controls.

All ESi products are tested in the UK so we are confident this product will reach you in perfect condition and give you many years of service. However, for additional peace of mind, we recommend you register your product online at www.esicontrols.co.uk/warranty for your extended warranty.

Contents

User Instructions

1 Quick Operating Guide

1.1	Display and Button Functions.....	6
-----	-----------------------------------	---

2 Operation Modes

2.1	Manual Mode.....	8
-----	------------------	---

2.2	Auto Mode.....	8
-----	----------------	---

2.3	Once.....	9
-----	-----------	---

3 Boost.....9

4 Set Temperature.....10

5 Factory Reset.....10

6 Program Settings

6.1	Factory Pre-Set Program.....	11
-----	------------------------------	----

6.2	Default Program Settings: 5/2 Day.....	12
-----	--	----

6.3	Program Settings: 7 Day.....	12
-----	------------------------------	----

6.4	Program Settings: 24 Hour.....	12
-----	--------------------------------	----

7 Holiday Mode.....12

User Instructions

1. Quick Operating Guide

1.1 Display And Button Functions

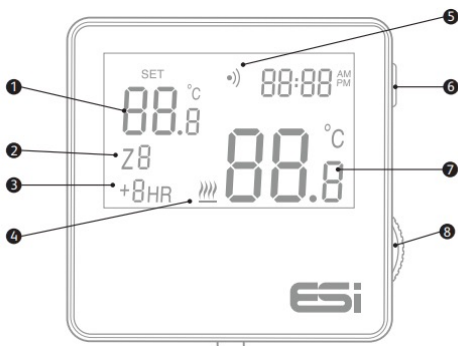

1. Set Temperature
2. Connection Status (Standalone or RF Connected)
3. Boost Status
4. Flame Symbol When System Is Calling For Heat
5. RF Working Status
6. MODE Button
7. Temperature
8. Dial To Adjust Temperature and Parameters

Button Functions (Inner)

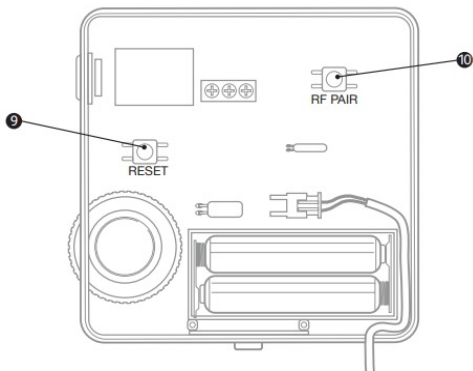

9. RESET Button

10. RF Pair Button

2. Operation Modes

2.1 Manual Mode

By default, your ESRTPRFK will start in MANUAL mode. Use the dial to select your SET temperature, (Default 25c). The ESRTPRFK will permanently aim to maintain the room at your SET temperature.

N.B. The room thermostat will show Z1 to indicate which zone is being controlled

2.2 Auto Mode

AUTO Mode will be available if your ESRTPRFK Room Thermostat is connected to a compatible programmer (ES3247BRF).

1. On your RF Programmer, move the slider to the **PROG** position
2. Select zone 1 or zone 2 by pressing the **Next ►►** button.
3. Use the **+/-** buttons to select AUTO.
4. Move the slider to **RUN**.

On the Centro app – if your thermostat is connected to a smart phone or tablet via the optional Wi-Fi Hub or via a Wi-Fi room thermostat, select **HEATING CONTROL**, then select **SCHEDULE**. You can also modify the **ON** and **OFF** times for your Room Thermostat.

2.3 ONCE

When **ONCE** has been selected, your Room Thermostat will switch on at the first scheduled **ON** time each day and it will switch off at the last scheduled **OFF** time each day.

1. On your RF Programmer, move the slider to the **PROG** position
2. Select zone 1 or zone 2 by pressing the **Next ►►** button.
3. Use the **+/-** buttons to select **ONCE**.
4. Move the slider to **RUN**.

3. Boost

When your ESRTPRFK room thermostat is in **AUTO** mode, it allows for a temporary override of up to 3 hours to the schedule.

1. When in **AUTO** mode, press the **MODE** button. The display will show **+1HR**.
2. Your ESRTPRFK will enter **BOOST** mode for one hour or until the next program starts.
3. Press the **MODE** button again to select **+2HR** or **+3HR** of **BOOST** time.
4. To turn **BOOST** off, press the **MODE** button repeatedly until **+1HR**, **+2HR**, **+3HR** are no longer shown on the display.

When **BOOST** is active, the display will also show the target temperature, the room temperature and the flame symbol as long as the SET temperature is higher than the ambient temperature.

N.B. *On the Centro app, the hours (**BOOST**) numerically count down. When the countdown has finished normal operation will resume.*

4. Set Temperature

Use the dial on the side of room thermostat to select a SET temperature. The ESRTPRFK will call for heat when it recognises that the room temperature is lower than the SET temperature and will stop calling for heat when the SET temperature is satisfied.

Temperature range: 5.0°C – 35.0°C.

5. Factory Reset

This function will reset all parameters to the factory default.

1. Press the release button on the bottom of the thermostat to open it. *(See Image 1 below)*

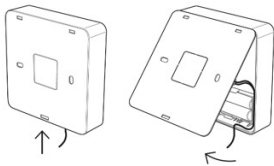

Image 1

2. Press the **RESET** button (See Page 7) until the display goes blank.
3. The display will restart and it will show all LCD characters.
4. The unit will load the default parameters. When complete it will return to the home screen.

6. Program Settings

6.1 Factory Pre-Set Program

This is only available when your ESRTPRFK is paired with a compatible Programmer (ES3247BRF).

This unit has been designed to be a simple to use thermostat, requiring minimal user intervention with a pre-programmed heating profile. The pre-set heating times and temperatures will suit most people (see table below).

Event	Time (ON)	Time (OFF)	Event	Time (ON)	Time (OFF)		
Weekdays	P1	06:30	08:30	Weekends	P1	07:30	10:00
	P2	12:00	13:00		P2	12:00	13:00
	P3	17:00	22:30		P3	17:00	22:30

6.2 Default Program Settings: 5-2 Day

5-2 Day setting will allow the end user to set a heating profile for weekdays and a separate heating profile for weekends. This will overwrite the pre-set profile shown in the table above.

6.3 Program Settings: 7 Day

In 7 Day setting, the unit allows for a different setting for each day of the week. Please note that in 7 Day setting, each day must be set separately. The preset settings are the same as 5-2 Day settings.

6.4 Program Settings 24 Hour

This is the most used setting. Every day will run the same programs so you will only need to input one set of times. The pre-set settings are the same as weekdays of 5-2 Day.

7. Holiday Mode

You can select Holiday Mode via the ESi Centro app. To access the ESRTPRFK via the Centro app, your room thermostat must be paired with a compatible RF programmer (ES3247BRF) and the optional Wi-Fi Hub (ESWIFIHUB)

In the Centro app settings you can go into the 'Set Holiday' option where you can set the departure date & time as well as the return date & time. Once these have been set, you can 'Activate Holiday Mode' which will start the Holiday function on all thermostat included in the Centro app.

If set correctly, all thermostats should be back to normal operation for when you return from holiday.

We are continuously developing our products to bring you the very latest in energy saving technology and simplicity. However, should you have any questions setting up your controls please email us at sales@esicontrols.co.uk

Warning: Interference with sealed parts renders the guarantee void.

In the interests of continuous product improvement we reserve the right to alter designs, specifications and materials without prior notice and cannot accept liability for errors.



Energy Saving Innovative Controls Limited

www.esicontrols.co.uk

Version 1.1.0

© ESi Controls Limited 2022

