



## Installing and using the ESi Centro App

---

# ESi Centro

## Download The ESi Centro App



iOS



Android

### Normal Configuration

Before pairing a room thermostat or Wi-Fi Hub to your home network, please ensure your router is broadcasting at 2.4ghz.



Create an account using an email address and memorable password.



Log in to your Centro account and tap **Remember me**. Tap **Login**.



The next screen will show all ESi Wi-Fi devices that are connected to your home network. To add a new device, tap the + icon at the bottom of the screen.



Choose your ESi device type from the list, e.g. Room Thermostat.



Choose your ESi device from the list, e.g. RTP6.  
**If you are pairing the RTP5, please skip to the section for ES RTP5WF.**



Tap the tick to confirm your device has been correctly installed.



Follow the instructions to set your thermostat into pairing mode.



Your thermostat will show a box scrolling around the display. Tap the arrow icon at the bottom of the screen.

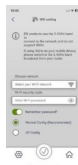

The network screen will appear with your router in the top box. Type your network password into the lower box. **This is case sensitive.** Slide the toggle to **Remember password**. Ensure **Normal Config** is selected. Tap the tick at the bottom of your screen.



Centro will search for your ESi device & will pair it with your home network.



When your thermostat has joined your home network you can rename it..

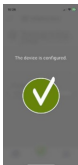

When you have renamed your thermostat, Centro will show that your device is configured.

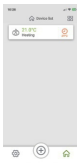

Centro will return to the device list which will show your newly installed and renamed thermostat.

## AP Configuration

The security software built into your Wi-Fi router can occasionally block the connection to your ESi device. If this happens, please follow the steps above until you arrive at the network screen, then follow the steps below.



Choose your network & add your Wi-Fi password, then select **AP Config**. Tap the tick at the bottom of the screen.



Tap **GO TO SETTINGS**.



Ensure **Local Network** is selected. Return to your Centro app & tap the arrow at the bottom of the screen.



On your room thermostat, hold the HOME button until AP shows on the display. Tap the arrow at the bottom of your phone screen.



Tap the arrow at the bottom of the screen.



Tap **Goto Wifi Settings**.



Your phone settings will open. Navigate to your phone's Wi-Fi settings and select **thermostat** as your network.



Return to your Centro app & tap the arrow at the bottom of the screen.



Your Centro app will connect directly to your thermostat, bypassing your router.



When your thermostat has joined your home network, you can rename it.

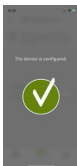

When you have renamed your thermostat, Centro will show your device is configured,

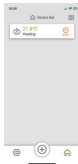

Centro will return to the Device list which will show your newly installed and renamed thermostat.

## **ESRTP5WE**



Follow the steps above until you arrive at the list of ESI devices. Select RTP5. Tap the tick at the bottom of the screen.



Tap the tick to confirm your thermostat has been installed correctly.



Follow the instructions to enter your thermostat menu. Tap the arrow at the bottom of the screen.



Use your thermostat dial to select **CoUP**. Press the arrow.



Tap the > button on your thermostat. Tap the arrow button on your Centro app.



Tap the barcode icon on your phone screen to open your phone's barcode reader. Scan the barcode on the sticker that came with your thermostat. Tap the arrow. **If you don't have the barcode supplied in the box, you can find a copy of it on the reverse side of your thermostat fascia.**



Your router should be listed in the top box, enter your router password. **This is case sensitive.** Press the tick.



Tap on **Remember Password** and ensure **Normal Config** is selected.



Centro will scan for your ESI device & will pair it with your home network.



When your thermostat has joined your home network you can rename it.

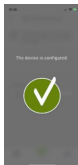

When you have renamed your thermostat, Centro will show that your device is configured.

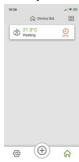

Centro will return to the device list which will show your newly installed and renamed thermostat.

### AP Configuration

The security software built into your Wi-Fi router can occasionally block the connection to your ESI device. If this happens, please follow the steps above until you arrive at the network screen, then follow the steps below.



Choose your network & add your Wi-Fi password, then select **AP Config**. Tap the tick at the bottom of the screen.





Tap **GO TO SETTINGS**.



Ensure Local Network is selected, Return to your Centro app & tap the arrow at the bottom of the screen.



On your room thermostat, hold the > button until **AP** shows on the display. Tap the arrow at the bottom of your phone screen.



Tap the arrow at the bottom of the screen.



Tap **Go to Wi-Fi Settings**.



Your phone settings will open. Navigate to your phone's Wi-Fi settings and select thermostat as your network.



Return to your Centro app & tap the arrow at the bottom of the screen.



Your Centro app will connect directly to your thermostat, bypassing your router.



When your thermostat has joined your home network, you can rename it.

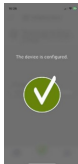

When you have renamed your thermostat, Centro will show your device is configured.



Centro will return to the Device list which will show your newly installed and renamed thermostat.

In the interests of continuous product improvement, we reserve the right to alter designs, specifications and materials without prior notice and cannot accept liability for errors.

---



We are continuously developing our products to bring you the very latest in energy saving technology and simplicity. However, should you have any questions regarding setting up your controls please email us at [tech@esicontrols.co.uk](mailto:tech@esicontrols.co.uk)  
**Version 1.0**